



20TN Drop-in Tee Nut

These are post insertion Tee Nuts that can be added anywhere along the slot of compatible extrusions/profile. These Drop-In Tee Nuts are great to have on hand because they do not need to be placed in from the ends of the extrusion. They can be easily placed in later in the building process.



Tip: Drop in Tee Nut is installed by placing them in the profile/extrusion-Slot. When the screw is engaged, it will turn them and engage them into the bottom side of the profile slot. Once tightened the teeth grab into the anodized coating, to ensure a no-slip connection.

SKU: [MCH-1180](#)

Brief Data:

- Part No: 20TN-M5.
- Fits M5 Screw.
- Size: 6 x 10.3 x 4.4mm.
- Carbon Steel.
- Color: Chrome-Plated Silver.

Mechanical Dimension:

Unit: mm

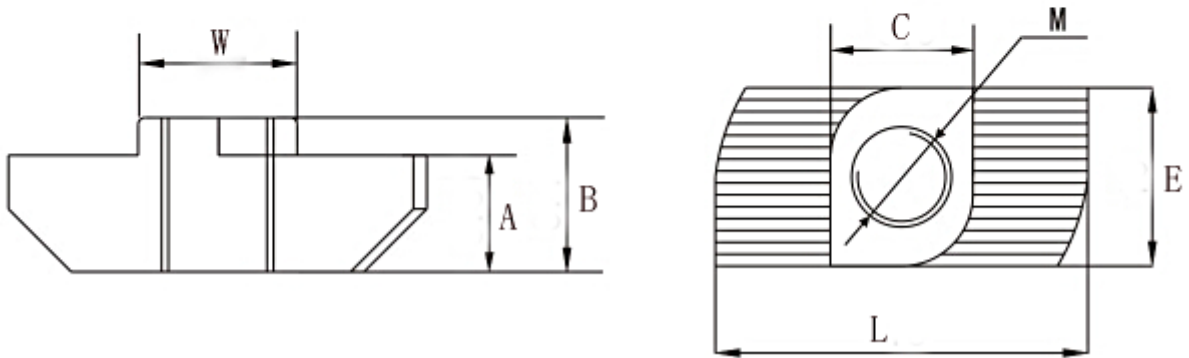
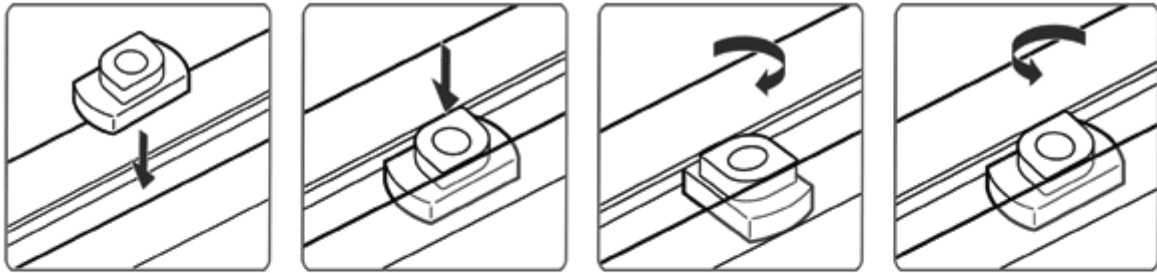

Model	L	E	A	B	M	C
20TN-M5	10.3	6	3.7	4.5	M5	6